

HD Rapid Dome Cameras from Sony

The SNC-RH124 and SNC-RH164 are network HD rapid dome cameras supporting H.264, MPEG-4, and JPEG compression formats, that deliver excellent picture quality at HD resolution (1280 x 720, 30 fps) in 16:9 aspect ratio.



With a total tilt range of 210° and 360° endless high-speed pan capability, they can cover a wide monitoring area with great efficiency.

Packed with a host of features and capabilities such as XDNR for clear low light images, and Visibility Enhancer to allow viewing of high contrast images. They allow users to clearly capture images that have proved challenging in the past.

These new cameras open up a whole new world of video security applications, such as casino surveillance, town monitoring, and traffic/highway observation to name just a few.



FEATURES

- HD*1 with 30 fps **HD**
- 10x Optical Zoom
- XDNR (Excellent Dynamic Noise Reduction)
- Visibility Enhancer
- DEPA™ Advanced 
- 210° Tilt
- Quick Release for Easy Installation
- hPoE (Compliant With IEEE802.3at*2)
- Triple Codec: H.264/MPEG-4/JPEG
- ONVIF Compliant 

*1 1280 x 720 (30 fps Progressive)

*2 Tentative SNC-RH124 only

210° Tilt

The cameras cover a wide monitoring area with great efficiency.

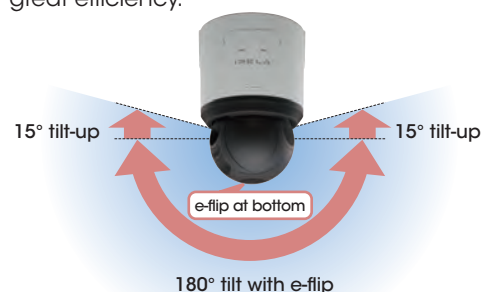

Quick Release

The camera can be detached quickly and easily.



Indoor model

Press Release Button and pull



Outdoor model

Remove Top Sunshade, Rotate Main Unit and pull (Need to remove Locking screws)

Visibility Enhancer

To suppress the extreme whites in a scene, and boost dark areas in a scene at the same time dynamically to produce clear images on the monitor.



OFF
(Images simulated)

ON

SNC-RH124/RH164

Network Rapid Dome Cameras

Preliminary

SPECIFICATIONS

SNC-RH124		SNC-RH164
Camera		
Image device	HD CMOS	
Day/Night *1	Yes	
Wide-D *2	No *3	
Number of effective pixels (H x V)	Approx. 2 Megapixel	
Electronic shutter speed	1/2 to 1/10,000 s	
Auto gain control	Auto/Manual (-3 to +18 dB)	
Exposure control	Auto, Full auto, Shutter-priority, Iris-priority, Manual, EV compensation, Backlight compensation	
White balance mode	Auto, Indoor, Outdoor, One-push WB, Manual	
Lens type	Auto-focus zoom lens	
Zoom ratio	10x	
Horizontal viewing angle	5.4 to 50 degrees	
Focal length	f=5.1 to 51mm	
F-number	F1.8 (wide), F2.1 (tele)	
Pan angle	360 degrees endless rotation	
Pan speed	400 degrees/s (max.)	
Tilt angle	210 degrees (with e-flip)	
Tilt speed	400 degrees/s (max.)	
Image		
Codec image size (H x V)	1280 x 720, 768 x 576, 640 x 480, 320 x 240 (H.264, MPEG-4, JPEG) (Tentative)	
Video compression format	H.264, MPEG-4, JPEG	
Maximum frame rate	H264/MPEG-4: 30 fps (1280 x 720) JPEG: 10 fps (1280 x 720) (Tentative)	
Audio		
Audio compression	G.711/G.726	
Scene analytics		
Simple activity detection	No	
Intelligent motion detection	Yes (with built in Post Filter)	
Network		
Protocols	TCP/IP, ARP, ICMP, HTTP, FTP (client/server), SMTP, DHCP, DNS, NTP, RTP/RTCP, SNMP (MIB-2) (Tentative)	
Wireless network	Yes (With Optional *4)	
Number of clients	10 (Tentative)	
Authentication	IEEE802.1X	
Analog video output		
Signal system	NTSC/PAL	
S/N ratio	more than 50 dB	
Interface		
Ethernet	10BASE-T/100BASE-TX (RJ-45)	
Serial interface	RS-232C/RS-422 (PELCO D protocol) (Tentative)	
Card slots	CF card x1	
Analog video output	Composite video (1Vp-p)	
Sensor input	x 4	
Alarm output	x 2	
External microphone input	Mini-jack (Monaural), MIC IN/LINE IN: 2.2k ohm, 2.45VDC plug-in power	
Audio line output	Mini-jack (Monaural), Max output level: 1 Vrms	
General		
Weight	Approx. 4 lb 10 oz (2.1 kg)	Approx. 9 lb 15 oz (4.5 kg)
Dimensions (ø x H)	6 1/8 x 9 inches (154 x 226 mm)	9 3/8 x 13 5/8 inches (238 x 346 mm)
Power requirements	hPoE (Tentative), AC24V, DC12V	AC24V
Power consumption	27 W max. (Tentative)	82 W max. (Tentative)
Operating temperature	32 to 122 °F (0 to 50 °C)	-40 to 122 °F (-40 to 50 °C)
Storage temperature	-4 to 140 °F (-20 to 60 °C)	
System requirements		
Operating system	Windows® XP, Windows Vista®	
Processor	CPU: Pentium4® 3GHz, Intel Core2 Duo™ 2GHz or higher	
Memory	1GB or more (Tentative)	
Web browser	Microsoft Internet Explorer® Ver6.0 or higher	
Supplied accessories		
	Base unit, Mounting bracket, Screws, Cables (Power input, BNC, I/O, Serial), Installation manual, CD-ROM (User's guide, SNC toolbox), Mounting template, Wire rope	Base unit, Top sunshade, Rotate-and-lock coupling, Waterproof plug, Screws, Installation manual, CD-ROM (User's guide, SNC toolbox), Wire rope

*1 Removable IR Cut Filter.

*2 DynaView Technology.

*3 The camera has a conventional backlight compensation function and Visibility Enhancer, which optimizes image contrast dynamically.

*4 With optional SNCA-CFW5.

SYSTEM CONFIGURATIONS

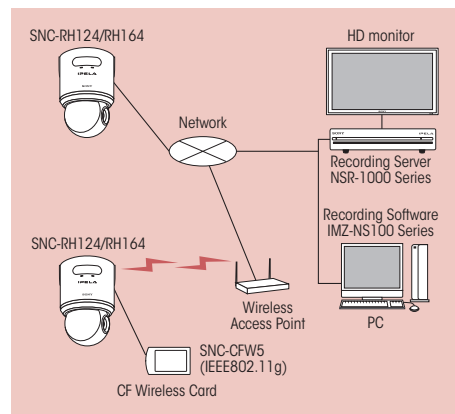

DIMENSIONS

SNC-RH124

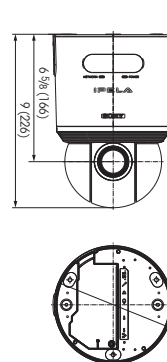

SNC-RH164

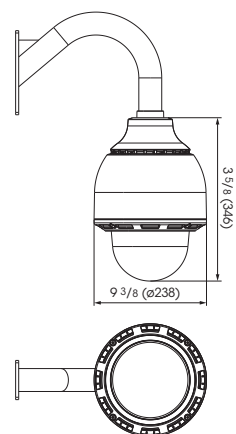

Unit: inches (mm)

CONFIGURATION

SNC-RH164



Install in indicated numerical order

SONY

Sony Electronics Inc.
1 Sony Drive
Park Ridge, NJ 07656
click: sony.com/security

S-IP2040 (MK10584V2)

© 2009 Sony Electronics Inc. All rights reserved.
Reproduction in whole or in part without written permissions is prohibited.
Features and specifications are subject to change without notice.
All non-metric weights and measurements are approximate.
Sony, IPELA and DEPA are trademarks of Sony.
Windows XP, Vista and Internet Explorer are trademarks of Microsoft Corporation.
Pentium4 and Core2 Duo are trademarks of Intel Corporation.

Printed in USA (3/09)